

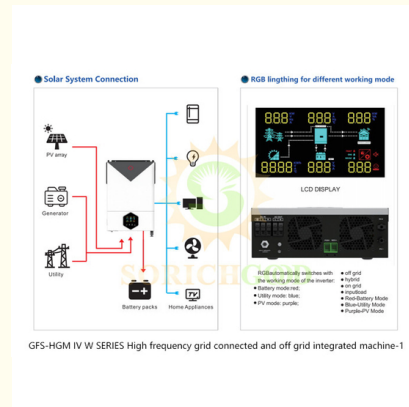

Versatile Hybrid Inverters with Dual Outputs and WiFi Monitoring

Basic Information

- Place of Origin: China
- Brand Name: GFS
- Certification: CE
- Model Number: HFPS5000
- Minimum Order Quantity: 50 units
- Price: consult prices online
- Packaging Details: consult online
- Payment Terms: T/T



Product Specification

- Maximum PV Input Power: 6500W
- MPPT Voltage Range: 90-450VDC
- Output Power Factor: 1.0
- Nominal Output Voltage: 220/230/240VAC
- Peak Power: 16400W
- Maximum Conversion Efficiency: 98%
- Highlight: Hybrid Inverters, Hybrid Inverters, Hybrid Inverter

Product Description

Versatile Hybrid Inverters with Dual Outputs and WiFi Monitoring

Product Description:

This product is a pure sine wave solar inverter designed for both on-grid and off-grid applications. It supports high-efficiency energy conversion with a built-in 120A MPPT solar charger capable of handling up to 6500W solar input. The inverter is equipped with dual outputs and is compatible with lithium batteries, making it a versatile solution for energy storage systems. Key features include WiFi & GPRS support for mobile monitoring, smart battery charging design to enhance battery lifespan, and an anti-aging kit to handle harsh environmental conditions.

Phase	Single phase			
Maximum PV Input Power	6200W	6500W	8200W	10200W
Rated Output Power	3600W	6200W	8200W/8200VA	10200W/10200VA
Grid Connected Operation				
PVinput(DO)				
NominalDCVoltage/Maximum DCVoltage	360VDC/500VDC			
Start-upVoltage/InitialFeeding Voltage	90VDC/120VDC			
MPPT Voltage Range	90VDC~450VDC			
Number of MPPTTrackers/Maximum InputCurrent 1/27A				
GRID oUIPUT(AO)				
Nominal OutputVoltage	220/230/240VAC			
Output Voltage Range	195.5~253VAC			
Nominal Output Current	15.7A 27.0A 35.6A 44.3A			
Power Factor	>0.99			
Grid Input Frequency Range	59-61±1Hz 49-51±1Hz			
EFFICIENCY				
Maximum Conversion Efficiency(DC/AO)	98%			
Output Load Power (V2.0)				
Full Load	3600W 6200W 8200W 10200W			
Main Load Cut Off Voltage	22VDC	44VDC	44VDC	44VDC
Main Load Recovery Voltage	24VDC 48VDC 48VDC 48VDC			

OFF-GRID OPERATION				
AC INPUT				
AC Start-up Voltage/Auto Restart Voltage	120-140VAC/180VAC			
Acceptable Input Voltage Range		90-280VAC or 170-280VAC		
Maximum AC Input Current	30A	40A	40A	50A
Nominal Operating Frequency 50/60Hz				
Peak Power	7200W	12400W	16400W	20400W
BATTERY MODE OUTPUT(AC)				
Nominal Output Voltage 24VDC 48VDC 48VDC 48VDC				
Waveform	Pure sine wave			
Efficiency(DCto AC) 94%				
BATTERY&CHARGER				
Nominal DC Voltage 24VDC 48VDC 48VDC 48VDC				
Maximum Solar Charging Current	120A	120A	160A	180A
Maximum AC Charging Current 100A 100A 140A 160A				
PHYSICAL				
Dimension,D*W*H 420*310*110mm 537*390*130mm				
Net Weight(kg)	10	11	14.2	14.5
Communication Port RS232/WIFI(Optional)				
ENVIRONMENT				
Humidity 5%~95%				
Operating Temperature -10~50°C				

Application:

This inverter is ideal for residential and commercial solar power systems requiring on-grid and off-grid operation. It can be used to provide uninterrupted power to household appliances, office equipment, and renewable energy setups. Its high PV input range (90-500VDC) and multi-phase support allow it to be utilized in diverse solar installations for energy storage and power supply management.

Shipping Methods

Supports global air and sea shipping.



RICHGOOD ENERGY CO.,LTD



willa@fuhaosolar.com



fuhaosolar.com

Rm3810 Baoli E Building Pa Zhou Haizhu district Guangzhou